



VacuQuicklift

With quick-release system – it couldn't be easier

Setup and application

The VacuQuicklift is available in two basic variants. On the one hand for purely horizontal transport and on the other with a tiltable version for tilting workpieces. All functions - suction, lifting, lowering and releasing - can be controlled with just one control lever. Intuitive operation, combined with the unique quick-release system for independent release, ensure the shortest cycle times.

Due to the modular construction of the VacuQuicklift, it can be adapted very easily and particularly quickly to a wide variety of requirements and circumstances. In addition to a quick-change system and a large number of different suction pads, rotary devices and radio remote controls are also available for the vacuum generators.

Furthermore, the VacuQuicklift can also be equipped with an extended operating unit, which allows workpieces to be picked up from low or very high heights while maintaining an ergonomic operating position. And of course, also with the tried & tested "Quick Release" function.

The VacuQuicklift has a very wide range of applications and not only makes your daily work easier, but also increases your work safety and optimizes your process reliability many times over. Because wherever loads of up to 50 kg have to be permanently lifted and transported, the VacuQuicklift supports employees and ensures a highly efficient and ergonomic workflow.

Areas of application:

- Picking cardboard boxes in logistics centers
- Transfers to/from and with stores of workpieces
- Board/sheet handling in wood and sheet metal processing
- Bricks and concrete components in the construction industry
- Loading and unloading of CNC processing machines
- Sacks in agriculture and bulk goods
- And much more!



Curious?

For application videos, all technical data and more about the VacuQuickLift simply scan the QR code.
#LiftWithTheBest

VacuQuicklift

Assembly overview

Vacuum generator



Vacuum pumps

Dry-running vacuum pumps with 25-40 m³/h and mounted vacuum filters are available for the VPL100-VPL140 series.

Silenced pumps

The dry-running vacuum pumps are also available in a silenced version, which ensures a significant reduction in noise.

Lifting units



Lifting unit with fixed head

For purely horizontal handling or moving loads.



Lifting unit with swivel head

For horizontal and vertical handling or tipping of loads

VacuQuicklift

Assembly overview

Control units



Control unit Quick Release

Suck - lift - lower - release: Control everything with just one control lever. It couldn't be faster or easier.



MultiStacker control unit

For handling from high, medium or low altitudes. The control unit with joint and extension always ensures an ergonomic operating position.



Sounds exciting?

More info, product images and application videos for the MultiStacker and more can be found on our blog. Just scan the QR code and #simplymovemore.



VacuQuicklift

Assembly overview

Equipment variants



Flange plate for suction cups

Fastening base plate for the fixed installation of suction cups.



Top quick release plate

For screwing onto the control unit for changing suction pads during operation.



Quick release plate below

For screwing onto each suction cup, which means that these can be changed easily and quickly for different requirements.



Rotary device

With optional locking module for every 90°. Turning of suctioned workpieces for stacking in changing layers.



Remote control

Energy saving at the push of a button. If desired, the vacuum generators can be easily controlled wirelessly.



Pneumatics module

An integrated compressed air supply is possible for special functions that require pneumatic functions.

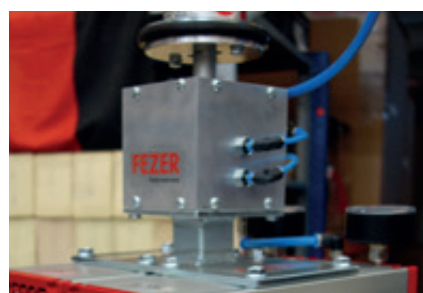

Pneumatic switching module

For the independent control of pneumatic gripping units when loading or unloading.

VacuQuicklift

Assembly overview

Suction cups



Single suction pads

In round flat or bellows design for handling containers and barrels.



Single suction pads

In a flat, rectangular design for small plates and workpieces with a solid surface.



Sack suction cups

With bellows suction cups and additional apron for sacks.



Sack suction cups

Lightweight plastic design with double seal for sacks.

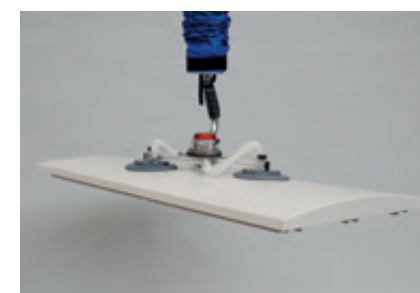

Double suction pad

With round bellows suction cups for smaller cardboard boxes and workpieces with curved surfaces.



Double suction pad

With rectangular suction cups for medium-sized panels and rigid cardboard boxes.



Quadruple suction cups

With round bellows suction cups. The suction cups are adjustable and clampable. Suitable for large panels and cardboard boxes.



Canister grabber

With balancing valve for handling canisters or containers with handles.



Universal hook grab

Mechanical hook gripper for hanging a wide variety of loads using crane hooks.

VacuQuicklift

Assembly overview

Suction cups



Mechanical lower gripper

with compensating valve for handling loads by reaching under.



Flat suction cups

With automatic switching control when putting on for suction and release.



Combi-gripper

With foldable lower grippers for packing racks in a box.



Canister gripper

Mechanical bottom gripper for containers or canisters with handles or brackets.



Cardboard gripper

With two bellows suction cups for optimal adaptation to surface curvatures.



Bellows suction cups

With additional sealing insert for handling workpieces with slightly rough surfaces.



High vacuum gripper

With pneumatic module, separate vacuum generator and manual slide valve for handling workpieces with small suction surfaces.



Box gripper

Mechanical gripper with clamp gripper for handling boxes and containers.

VacuQuicklift

Assembly overview

Suction cups



Combi-gripper

And the subsequent restacking of the packed boxes using a quadruple suction pad.



Multigripper

Our Multigripper was specially developed for our VacuQuicklift tube lifter and can easily suction loads with different sizes and surface conditions. Even small crevices and cracks are no obstacle. The special feature of this innovation? The total of 40 built-in nozzles and bellows suction cups ensure optimum surface adaptation and ensure that the "false air" sucked in by unoccupied suction cups does not cause any significant loss of performance.



Curious?

For more information and application videos on the Multigripper vacuum gripper, please visit our blog. Scan the QR code and #simplymovemore.

Sounds exciting?

You can find more info, product sheets and application videos about our different suction pads on our website. Simply scan the QR code and #simplymovemore.



VacuQuicklift

Technical specifications

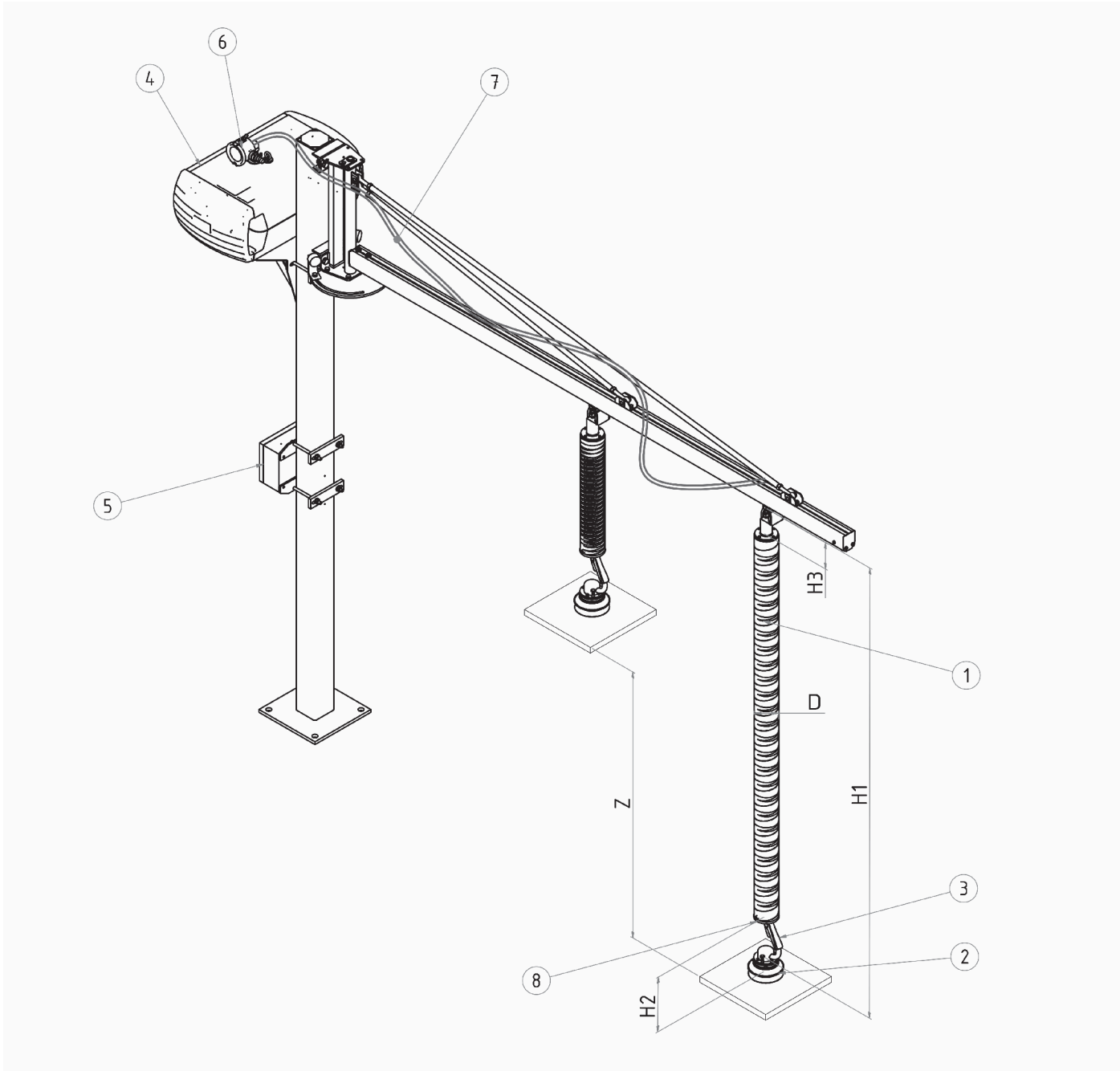

VacuQuicklift

Technical specifications

- 1** Lifting unit consisting of rotary head, lifting hose and suction head
In the event of a power failure, a safety valve in the rotary head lets loads that have been suctioned drop slowly and in a controlled manner to the ground.
- 2** Suction pads or gripper unit with individual adjustments
With a safety factor of 2.5, they ensure the necessary support for safe handling of the loads.
- 3** Accessories for suction feet. Quick change couplings, rotating devices
- 4** Robust and powerful vacuum generator
Ensure the build-up of the required vacuum and fast handling processes.
- 5** Motor protection switch or radio remote control
Protect the vacuum generators from overload and offer the option of remote control via the control unit.
- 6** Large dimensioned vacuum filters
With replaceable cartridges, the vacuum generators protect against dirt and damage.
- 7** Feed hose
Connects the vacuum generators to the lifting unit. Lengths of up to 50 meters and more are possible.
- 8** Adjustment screw for working height without load
This allows the hose lifter to be brought to an ergonomic basic height.

Type	Load dense/porous	Handling	Workpiece dimensions		Vacuum generator	Lift speed	H1	H2	H3	D	Z	Own weight*
	(kg)		min (mm)	max (mm)	(m³/h)	(m/min)	(mm)	(mm)	(mm)	(mm)	(mm)	(kg)
VQL100	35/30	horizontal	200x200	2.000x1.000	T4.25	25-55	2.320/2.800	235	100-250	100	1.400/1.700	6-10
VQL100-90	35/30	schwenken	200x200	2.000x1.000	T4.25	25-55	2.320/2.800	235	100-250	100	1.400/1.700	6-10
VQL120	50/40	horizontal	200x200	2.000x1.000	T4.40	25-55	2.320/2.800	235	100-250	120	1.400/1.700	6-10
VQL120-90	50/40	schwenken	200x200	2.000x1.000	T4.40	25-55	2.320/2.800	235	100-250	120	1.400/1.700	6-10
VQL140	65/55	horizontal	200x200	2.000x1.000	T4.40	25-55	2.320/2.800	235	100-250	140	1.400/1.700	8-12
VQL140-90	65/55	schwenken	200x200	2.000x1.000	T4.40	25-55	2.320/2.800	235	100-250	140	1.400/1.700	8-12

*depending on the suction cups used